

HS-215SHB-IN Enhanced Outdoor- housing



Key Features

- Anti-corrosive and ultraviolet-proof material to enhance outdoor durability
- Combined with adjustable sun shade from direct solar radiation
- Build-in temperature controlling
- Heater on with simultaneous fan against foggy glass cover
- Easy and flexible installation with side open structure
- IP66-rated

Specifications

Housing	HS-215SHB-IN
Indoor/Outdoor	Indoor or Outdoor (including sun shade, heater and fan)
Ingress Protection	IP66
Power Supply	AC 24V
Power Consumption	Heater: 40W Fan: 4.3W
Operating Condition	-40°C ~60°C (-40°F ~ 140°F) Humidity ≤ 90% RH(non-condensing)
Temperature Controlling	Heater runs below 5 ± 5°C (with fan on simultaneously) Fan runs above 40 ± 5°C
Dimensions (L × W × H)	Outside: 430×170.6×104mm (16.9"×6.7" ×4.1") Inside: 280×100×80mm (11.0"×3.9"×3.1")
Weight	2.08 kg (4.6lb)
Material	Shell: aluminum alloy Front and rear lids: plastic ABS

Dimensions

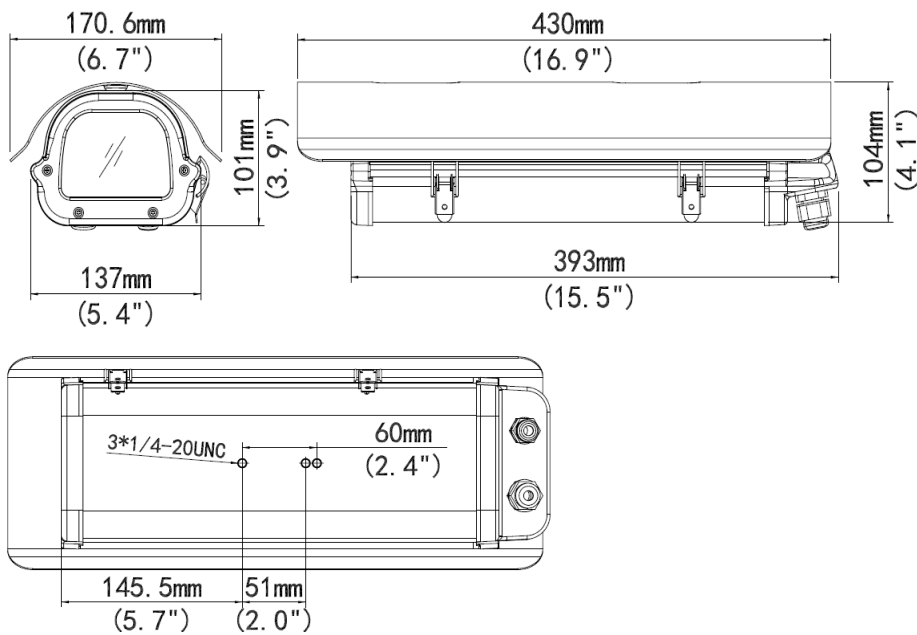

Accessories

Installation mode	Accessories	Description
Pendant mount	TR-CM06-IN	/
Wall mount	Indoor:TR-WM06-A-IN Outdoor: TR-WM06-B-IN	/
Rail mount	TR-UV06-A-IN + TR-UP06-IN	/
Standing pole mount	TR-WM06-B-IN + TR-UP06-IN	/
Pole mount	TR-UV06-A-IN	/

Zhejiang Uniview Technologies Co.,Ltd.

South Tower, Building 10, Wanlun Science Park, 88 Jiangling Road, Hangzhou, P.R.China 310051

Email: overseasbusiness@uniview.com; globalsupport@uniview.com

<http://www.uniview.com>

©2013 Zhejiang Uniview Technologies Co.,Ltd. All rights reserved.

*Product specifications and availability are subject to change without notice.